

Description

Waterproof OptiTap SC APC Field Installable reinforced Connector is a type of waterproof& reinforced connector which can be used with 2*3.0mm, 2*5.0mm flat drop cable. Its innovative design enables it to be compatible with Corning's OptiTap SC without infringing on Huawei's patents.

This Fast type Hardened OptiTap SC APC Connector includes a conventional FTTH fast connector and a protective cover compatible with Corning's OptiTap interface. It can achieve quick connection through simple assembly. It is an excellent solution to be compatible with Huawei devices and do not need terminated the connector in laboratory, it can be filed assembled very easily when the Corning connector defects.

This waterproof and durable connector offers a robust design for reliable performance in extreme environmental conditions, making it the perfect choice for FTTA, broadband, and telecom applications. Its compact size, blind-mating mechanism, and ease of installation make it ideal for both new installations and quick field repairs.



Optical Specifications

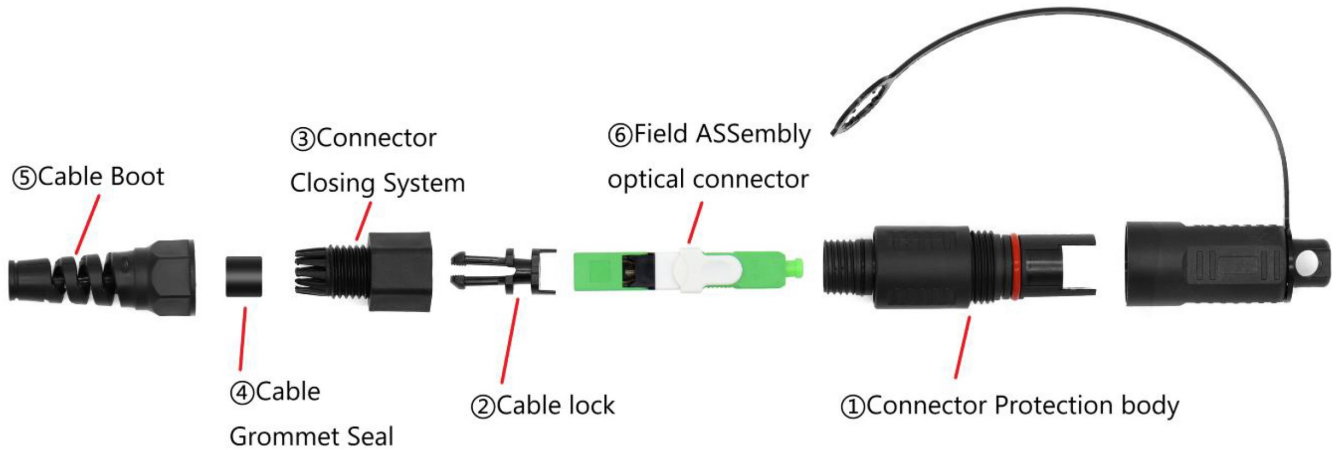

Item	Parameter
Products Name	Waterproof OptiTap SC APC Field Installable reinforced Connector
Part No.	O-SC-FC-001
Cable Compatibility	2*3.0mm, 2*5.0mm flat drop cable, round 3.0mm cable, round 2.0mm drop cable
Mode	SM
Operation Time	about 30s (exclude fiber presetting)
Insertion Loss	$\leq 0.3\text{dB}$ (1310nm & 1550nm)
Return Loss	$\geq 50\text{dB}$ for UPC, $\geq 55\text{dB}$ for APC
Success Rate	>98%
Reusable Times	>10 times
Temperature	-40 ~ +85 C
On-line Tensile Strength Test (20 N)	IL $\leq 0.3\text{dB}$
Mechanical Durability (500 times)	IL $\leq 0.3\text{dB}$
Drop Test (4m concrete floor, once each direction, three times total)	IL $\leq 0.3\text{dB}$

Suitable standard Fast Connector: J-R-SSA-52B

Installation and Maintenance

1, Insert the parts in numerical order then install the connector

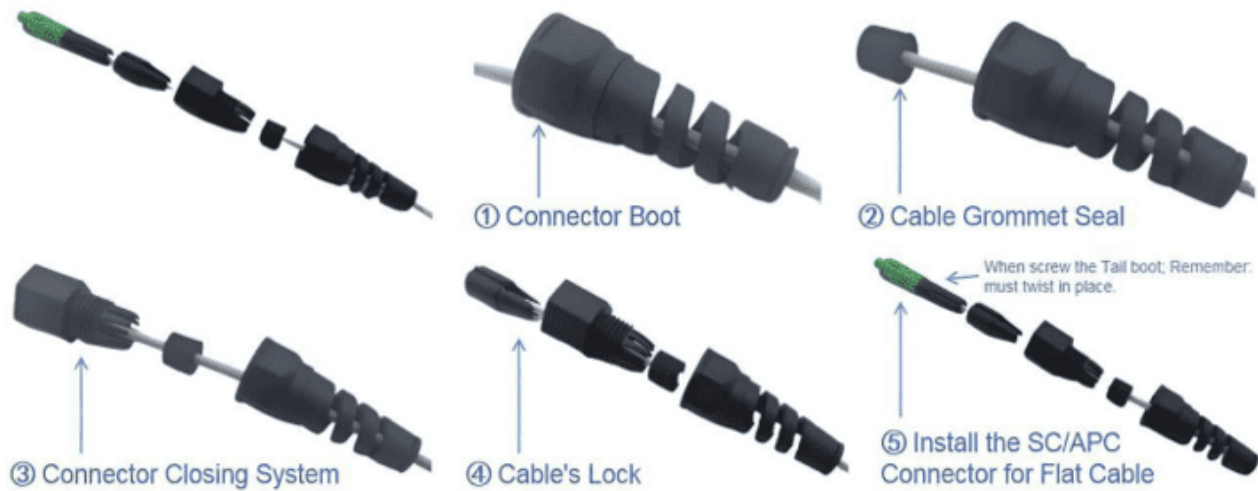

2, Remove the outer housing from the connector

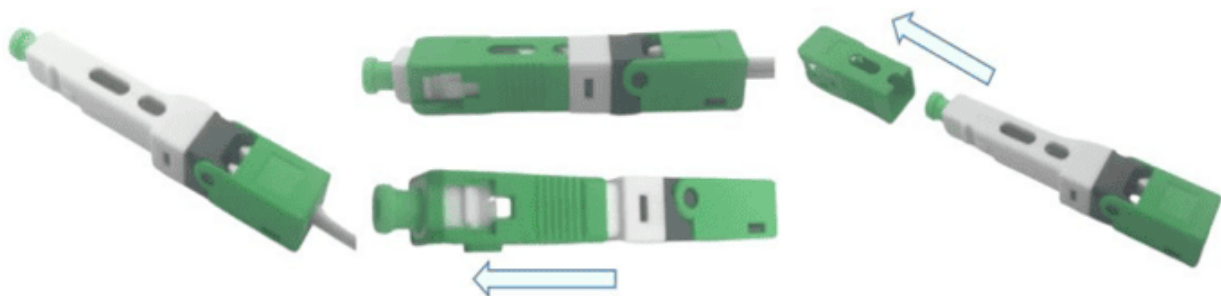

- Grip the connector's outer shell(green) like the upper picture;
- Push the outer shell on the table until removing the shell like the upper picture.

3, Insert the connector to the Connector's Protection body

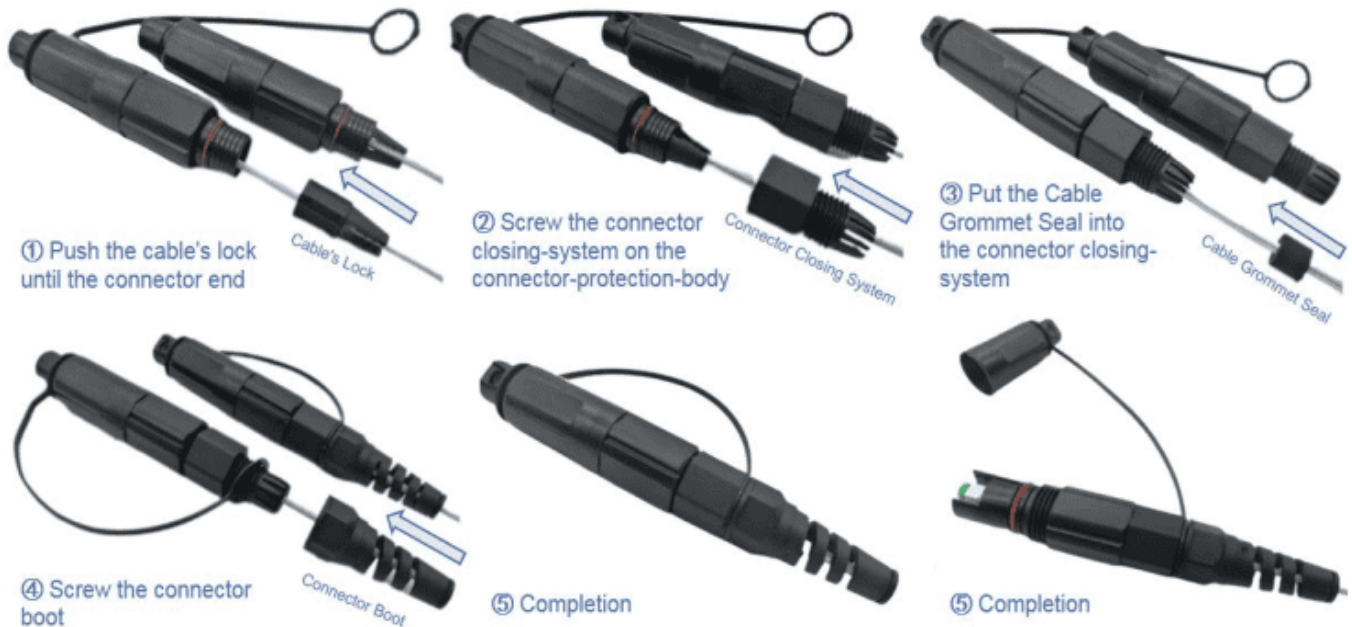

4, Install each parts



Field-Friendly Design: The push-pull insertion and bayonet-style latch ensure secure, tool-free assembly in the field.

Simple Maintenance: Durable construction minimizes maintenance needs, even in harsh environments, ensuring long-term performance.

Protective Design: Inside cover shields ferrule end face from damage, maintaining optimal signal clarity.

Features

Waterproof IP67 rated. Provides excellent water, dust, and corrosion resistance.
Suitable for different types cables. including 2.0mm, 3.0mm, and 5.0mm options.

Fast Connect type for filed assembly.

Tool-free assembly with a push-pull insertion mechanism.

Rapid connection to external flush-mounted bulkhead adapter to closure or terminals.

Durable Material: PEI construction for UV, acid, and alkali resistance.

High Reliability: Withstands up to 1,000 insertion cycles and cable tension up to 70N.

Applications

Compatible with Corning Device.

FTTH and FTTA networks for outdoor fiber connections.

Telecom networks, including 5G base stations.

Telecom Networks: Ideal for MST terminal boxes and outdoor SC ports.

Data Transmission Networks: Maintains high-speed connectivity in harsh environments.

Outdoor Cable Repairs: The best solution for quick field fixes without the need for pre-terminated connectors.

