

# FIBER PATCH CORD & PIGTAIL

SN CABLE ASSEMBLIES

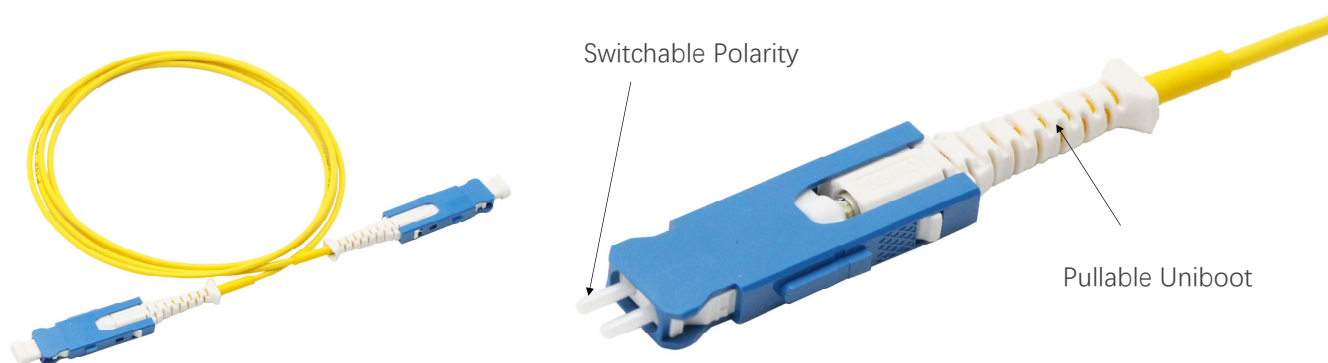

## Description



The SN® connector is the ultimate Base-2 connector combining 'best-in-class' packing density with carrier-grade performance and reliability. Designed and optimized for next-generation data rates, the SN® connector offers network operators the chance to densify their existing legacy infrastructure whilst at the same time providing an upgrade path to 400G and beyond.

The SN® Standard connector is suitable for termination to either 1.6 mm or 2.0 mm round cable that incorporates a ruggedized jacket and internal strain relief.

The SN® Standard connector has an integrated 'push-pull' boot that simplifies insertion and removal of the connector even in dense patch panels where finger access is limited. A gang-clip can be added to four individual SN® connectors allowing them to be patched simultaneously to either adapters or 4-channel (8 fibers) transceivers (subject to product selection).

OMC's SN Patch cord are manufactured and tested in compliance with TIA 604 (FOCIS), IEC 61754 and YD/T industry standards. OM1, OM2, OM3, OM4, OM5 or OS2 fiber types to meet the demand of Gigabit Ethernet, 10 Gigabit Ethernet and high speed Fiber Channel. Every termination through rigorous parameter test to ensure the highest in network performance.

## Optical Specifications

Insertion loss (SM)	0.15dB (SM UPC Premium low loss) 0.20dB (SM UPC Premium loss) 0.15dB (SM APC Premium low loss) 0.25dB (SM APC Premium loss)	Insertion loss (MM)	0.15dB (MM Premium loss)
Return loss	SM UPC ≥ 50dB SM APC ≥ 60dB MM PC ≥ 25dB	Durability	500 matings per TIA-568
Operating temperature	-40~75°C	Maximum pulling force	40N(1.6mm OD unitube cable) 50N(2.0mm OD unitube cable)

### 3D Geometric Specification(The 3D pass rate of the connector end face is 80%)

Items		Parameter	
Polishing		PC	APC
ROC	SC/FC/ST	10 ~ 25	5 ~ 12
	LC/MU	7 ~ 25	5 ~ 12
Apex Offset		≤ 50	
Fiber Spherical Height		±100	
Angle		± 0.5	8 ± 0.5

Note: 100% 3D Interferometer testing is available if customer request

## Ferrule Endface

Zone	Range (μm)	Scratches	Defects	Reference
A: Core	0 to 25	None	None	IEC 61300-3-35:2015
B: Cladding	25 to 115	None	None	
C: Adhesive	115 to 135	None	None	
D: Contact	135 to 250	None	None	
E: Rest of ferrule		None	None	

## Cable Details

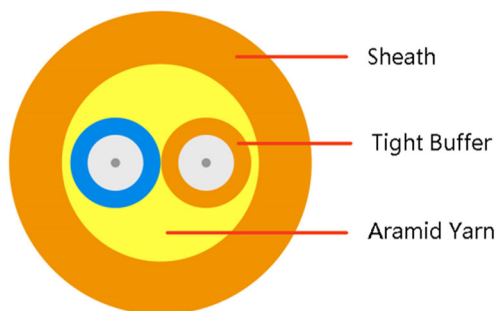

Fiber Type	G652D,G655,G657A1,G657A2,G657B3,OM1,OM2,OM3,OM4,OM5
Fiber Color	natural
Tight buffer OD	0.6±0.05
Tight buffer Material	LSZH or PVC
Tight buffer color	Yellow;White
OD optional	1.6mm/2.0mm
Coating Material	PVC, OFNR, OFNP, LSZH, LSOH, TPU
Strength member	Aramid Yarn or Polyester yarn
Cable weight	3.5kg

## Connector Details

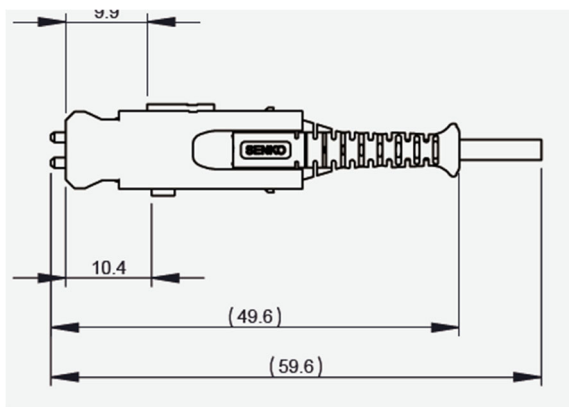
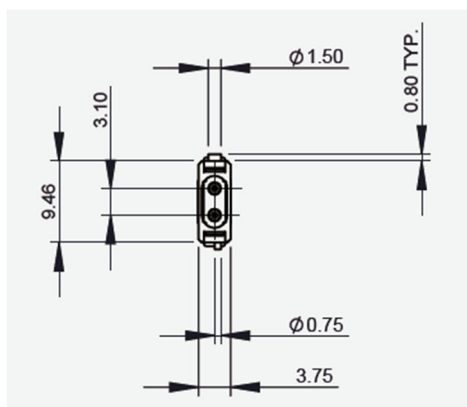

# FIBER PATCH CORD & PIGTAIL

SN CABLE ASSEMBLIES



**Available For Below cable assemblies**

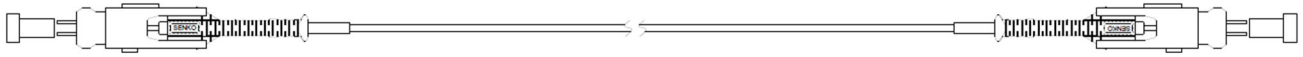

SN-SN PATCH CORD

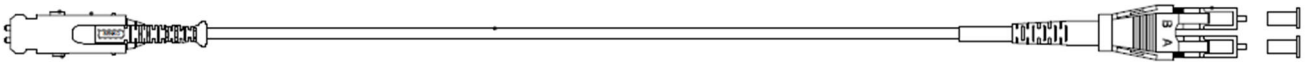

SN-LC PATCH CORD

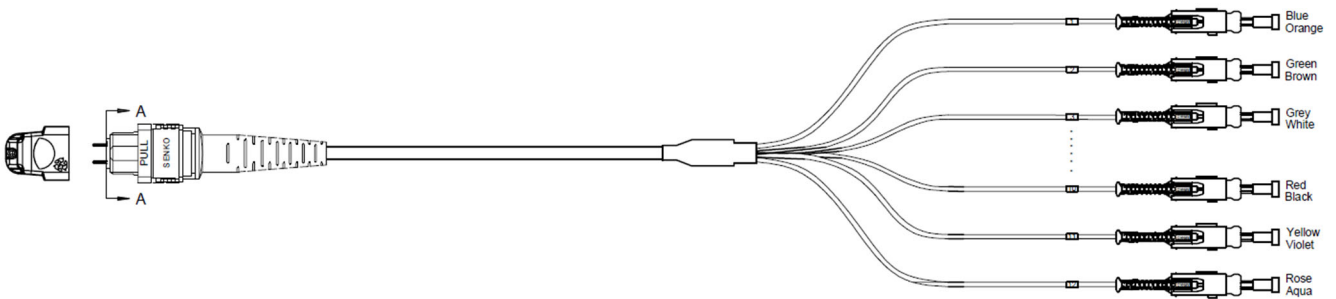

MPO-SN PATCH CORD