

SPECIFICATION

1-12C BUTTERFLY FLAT INDOOR FTTH DROP CABLE SC&LC PATCH CORD/PIGTAILS

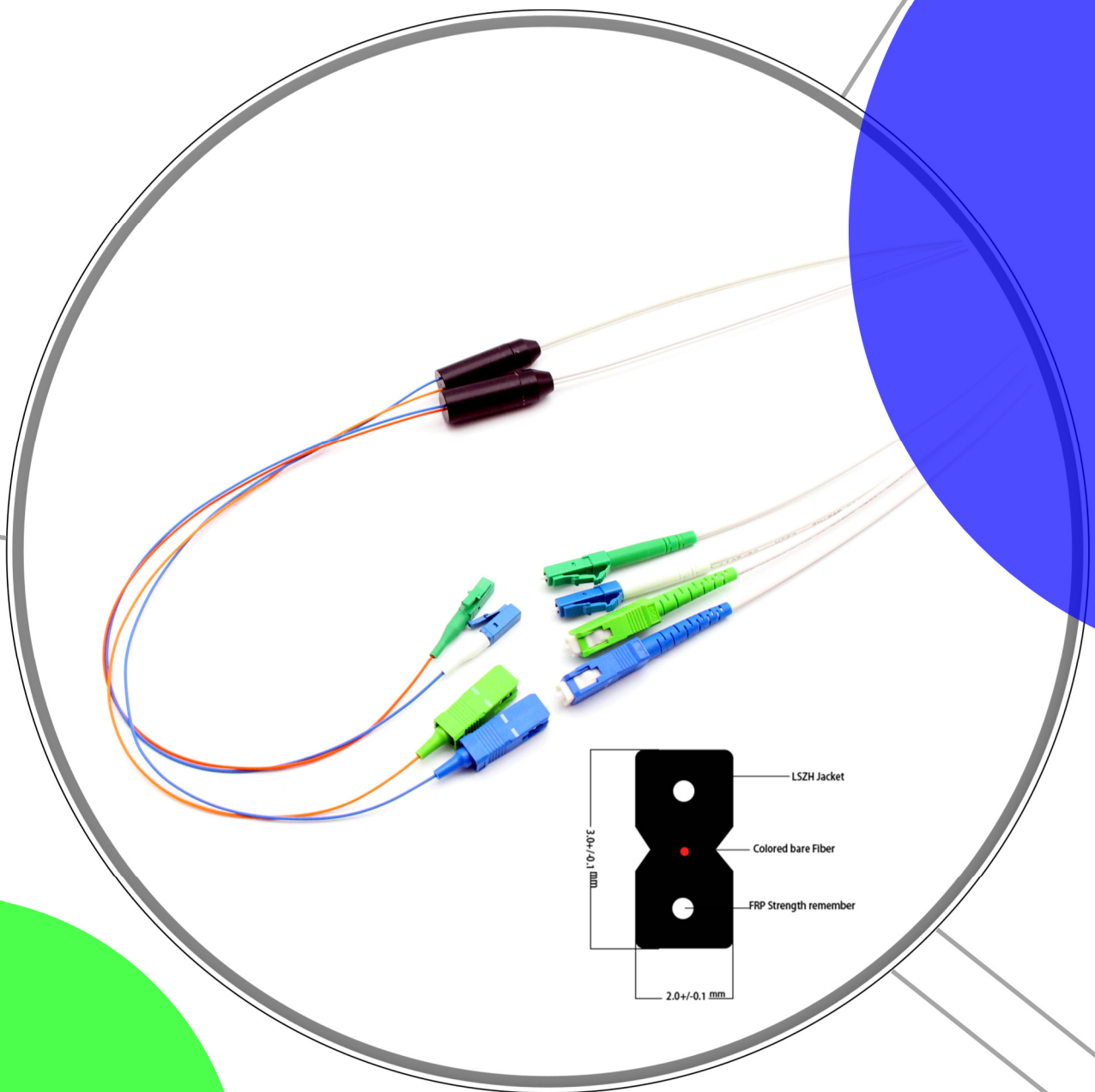



1-12 Cores Butterfly Flat Indoor FTTH Drop Cable Patch cord/Pigtails-SC&LC

Description

It's a kind of patch cord/Pigtail but assembly with **Butterfly Flat Indoor FTTH Drop Cable**. With easy accessibility to the fiber and simple installation, FTTH cable can be directly connected to the homes. This is a last cable in FTTH project. Used widely between Face plate, terminal box between ONU/ONT.

Cable structure

FTTH Indoor Drop Cable uses butterfly flat structure, whose optical fiber unit is positioned in the center. Two parallel Fiber Reinforced Plastic (FRP) or Steel wire strength members are placed at the two sides. Then, the cable is completed with LSZH sheath. FTTH indoor cable has a much greater bandwidth to carry data and less susceptible to interference than common indoor fiber cables. With small diameter, water-resistant, soft and bendable characteristics, it's easy to deploy and maintenance. In addition, the non-metallic strength member can provide lightning protection and anti-electromagnetic interference. FTTH cables are ideal for indoor cabling, end users directly cabling, and access network.

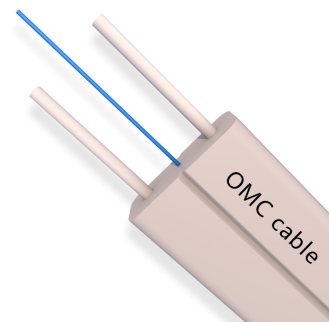

Cable Technical Data

Fiber Count	1F	2F	4F	6F-12F
Strength member(mm)	FRP/KFRP/ Solid Steel wire			
	0.45-0.52	0.45-0.52	0.45-0.52	0.45-0.52
Cable diameter(mm) Approx.	2.0*3.0(±0.1) 2.0*1.6(±0.1)	2.0*3.0(±0.1)	2.0*3.0(±0.1)	4.0(±0.2) *2.8 (±0.2)
Cable weight(kg/km) Approx	7.5/10.5	7.5/10.5	8.5/11.5	26.5/30.5
Tensile Strength Short/ Long Term (N)	200/100 for steel wire strength member 80/40 for KFRP wire strength member			
Outer sheath	LSZH in White/Black/——-colors			
Crush resistance short/long term (N/100mm)	1000/500			
Operating temperature range(°C)	-40°C ~+70°C			

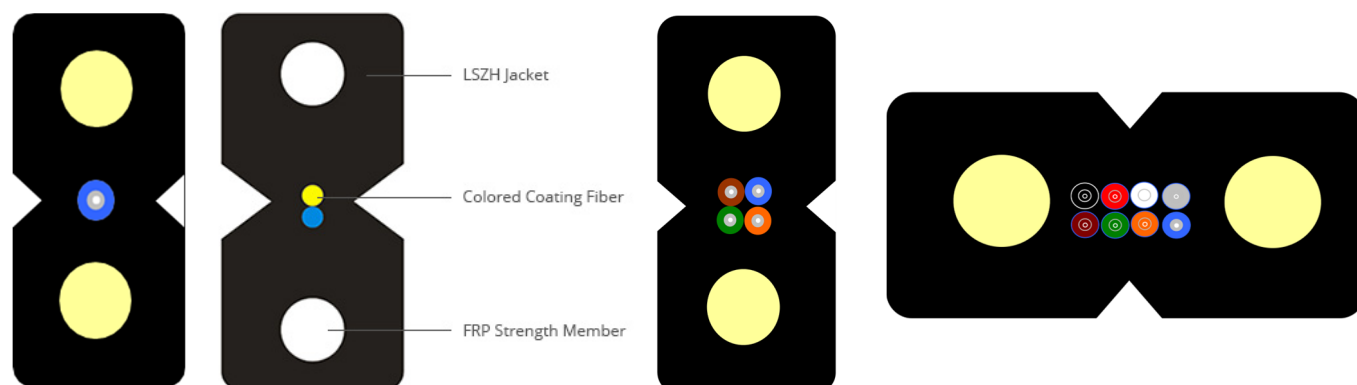



1-12 Cores Butterfly Flat Indoor FTTH Drop Cable Patch cord/Pigtails-SC&LC

Connector's Standard:

SC: TIA/EIA, FOCIS3, GR-326.NTT-SC IEC61754-4 and JIS C5973.

LC: TIA/EIA, FOCIS10, GR-326 EIA/TIA-604-10, IEC61754-20 and JIS C5973.



High quality SM ceramic ferrule,
Good concentricity<0.5um

Optical performance.



Test Item		Test Condition	Value(dB)	
			UPC	APC
Optical Performance	Insertion Loss	1310nm LED light source	<0.3	<0.3
	Return Loss	1310nm LED light source	>50	>60
Environmental Performance (Max. Insertion Loss change)	High temperature	+85°C168 hours	<0.2	
	Temperature Cycle	-40~+75°C, 21 Cycles 168 hours	<0.2	
	Humidity Aging	+75°C, 95%R.H,168 hours	<0.2	
	Humidity/Condensation Cycling	-10°C~+65°C, 90%~100%RH, 14 cycles 168 hours	<0.2	
Mechanical Performance (Max. Insertion Loss change)	Vibration	10-55Hz, 1.5mm(p-p)	<0.2	
	Flex	0.9kg,-90~+90°repeat for 100 cycles	<0.2	
	Torsion	1.35kg,90~+90°,10times	<0.2	
	Withstand tensile	90N,10min	<0.2	
	Drop	H=1.5M,Total of 8 drops	<0.2	
	Exchangeability	Randomly	<0.2	
	Durability	500 times	<0.2	

Polishing Method



APC(8 Angled Polished connector)

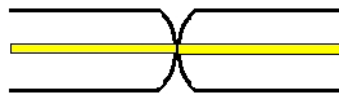

UPC(Ultra-Polished connector)

End-face Quality (SM)



SM APC



SM UPC

Zone	Range (μm)	Scratches	Defects	Reference
A: Core	0 to 25	None	None	IEC 61300-3-35:2015
B: Cladding	25 to 115	None	None	
C: Adhesive	115 to 135	None	None	
D: Contact	135 to 250	None	None	
E: Rest of ferrule		None	None	



1-12 Cores Butterfly Flat Indoor FTTH Drop Cable Patch cord/Pigtails-SC&LC

Packaging

This easily taken and well-protected fiber patch cable package has been labelled and marked by OMC as default . Which carton to be used depends on goods Qty . Packing can be customized.



1, Film wrap & PE Heat Sealing



2, Paper Carton



3, Fuming-free Pallet

OEM Services

1. Cable color, printing word, material of cable jacket, connector's color
2. OEM Label, Identify ring, cable's label, box, shipping marks
3. Different quality Level.

Application

FTTX Access Networks

Fiber Optic Communication System

FTTH (Fiber to The Home) Indoor Cabling project

Optical fiber connected and transmitted equipment

Ideal Solution for FTTH Indoor Cabling Project

Butterfly Flat Indoor Drop Cable is widely used in fiber to the home (FTTH) network system, which can directly connect the communication line from the Fiber access terminal box to the end users. Butterfly flat drop cable uses special low-bend-sensitivity fiber to provide high bandwidth and excellent communication transmission, it's very suitable for indoor cabling, end users directly cabling, and access network.

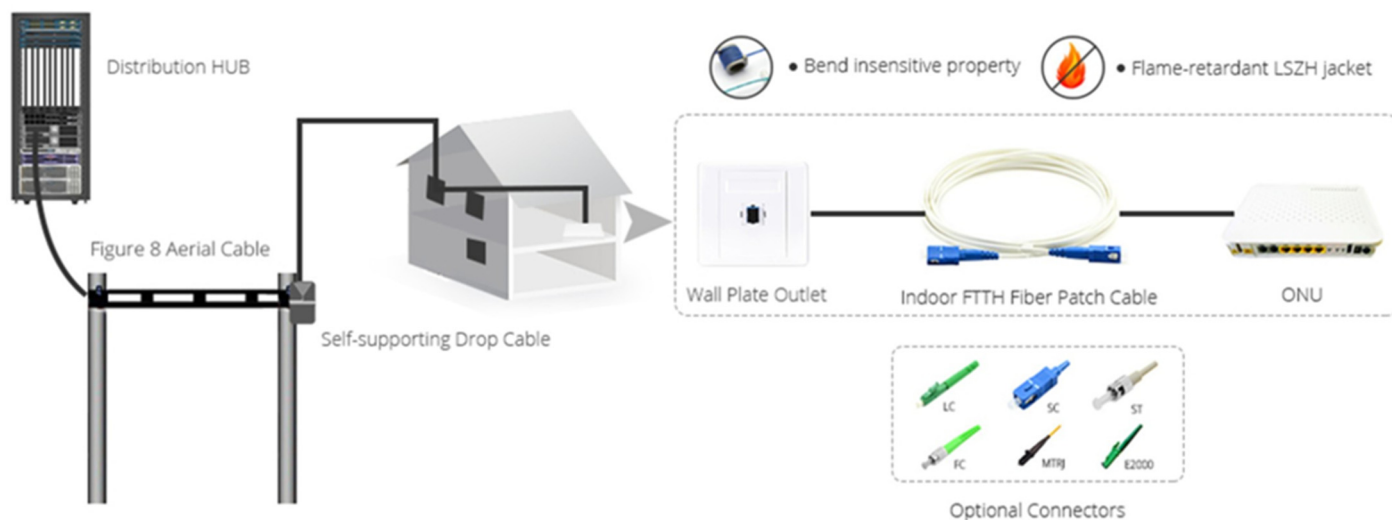



1-12 Cores Butterfly Flat Indoor FTTH Drop Cable Patch cord/ Pigtails-SC&LC

Products Family

1, 1C Cable assemblies



4, 2C Cable assemblies (fanout 0.9mm)



2, 2C Cable Assemblies (fanout 2*3mm)



5, 4C Cable assemblies (fanout 0.9mm)



3, 4C Cable Assemblies (fanout 2*3mm)



6, 8C Cable assemblies (fanout 0.9mm)



Order Instruction

Products	Fiber Count	Fiber Mode	Connector A	Connector B	Strength Member	Color	length
Drop cable patch cord and pigtail	1- 1 core	1 - G657A1	A LC UPC	0 Open(pigtail)	1 2 x FRP Wire	A- Blue	50=50M
	2 -2 cores	2- G657A2/B2	B SC UPC	A LC UPC	2 2 x KFRP Wire	B- Orange	
	4-4 cores	3 - G657B3	C LC APC	B SC UPC	3 2 x Steel Wire	C- Green	
	6-6 cores	4-OM1	D SC APC	C LC APC	A 1 x Solid Steel Wire+2 x FRP Wire	D- Brown	
	8-8 cores	5-OM2	E FC UPC	D SC APC	B 1 x stranded Steel Wire+2 x FRP Wire	E- Grey	
	T-12cores	6-OM3	F FC APC	E FC UPC	C 1 x Solid Steel Wire+2 x KFRP Wire	F- White	
		7-OM4	G SC APC+SC UPC	F FC APC	D 1 x stranded Steel Wire+2 x KFRP Wire	G- Red	
		8-OM5	H SC APC+LC UPC	G SC APC+SC UPC	E 1 x Solid Steel Wire+2 x Solid Steel Wire	H- Black	
			I SC APC+LC APC	H SC APC+LC UPC	F 1 x stranded Steel Wire+2 x Solid Steel Wire	I- Yellow	
			J SC APC+SC APC	I SC APC+LC APC		J- Purple	
			K SC UPC+LC UPC	J SC APC+SC APC		K- Pink	
			L SC UPC+LC APC	K SC UPC+LC UPC		L- Aqua	
			M SC UPC+SC APC	L SC UPC+LC APC		M-Magenta	
			O SC UPC+SC UPC	M SC UPC+SC APC			
			P LC UPC +LC UPC	O SC UPC+SC UPC			
			Q LC UPC +LC APC	P LC UPC +LC UPC			
				Q LC UPC +LC APC			