

DATASHEET

ST Fiber Optic Connector



RoHS



OMC INDUSTRY CO.LIMITED

Description

Optical Connector is a reusable passive component which could be applied in fiber and Cable connection. They are widely used in ODF, ODN,PON etc.

The ST connect was developed by AT&T shortly after the arrival of the FC. At a glance they can be mistaken for one another but the ST uses a bayonet fitment rather than a screw thread. Usage has declined in recent decades, for the same reasons as the FC. Additionally it cannot be terminated with an angled polish, which limits use in single mode fiber and FTTH applications.

Deployed predominately in multi-mode datacoms it is most common in network environments such as campuses, corporate networks and in military applications where the quick connecting bayonet had its advantages at the time. It is typically installed into infrastructures that were built at the turn of the century; when retro-fitting, STs are typically swapped out for more cost effective SC and LC connectors.

OMC manufactures many sorts of fiber connectors. Such as SC,LC,ST,FC,MU,MTRJ,E2000 ,MPO,MTP,SMA,DIN,D4 etc.

Industrial Standard:

ST: TIA/EIA, FOCIS2, GR-326. IEC61754-2 and JIS C5973 Etc.

Optical Performance:

Meets Telcordia GR-326-Core issue

IL(Typical):SM<0.3dB; MM <0.3dB:

RL(Typical):SM >50dB; MM >35dB:

Environmental Performance:

Operating Environment: -40°C ~ + 80°C

Meets UL94-V0 Flammability Requirements

ROHS compliant

Mechanical Performance:

Connection Durability: 500 Matings cycles

Connector Repeatability: MM<0.2dB; SM <0.1dB

Application

Patch cord&pigtail produce&Manufacture

Products Details

Fiber Connector	ST	Ferrule Material	Zirconia Ceramic
Housing	Metal	Boot Size	0.9mm, 2.0mm, 3.0mm
Operating Temp Range	-40~80°C	Boot color	SM: Blue/Black/white MM: Black/red APC: Green
Suit Cable	0.6-3.0mm OD cable	Available for	Not assembled Multi-Piece Pre-assembled one piece

Housing kits Type



Type 1



Type 2

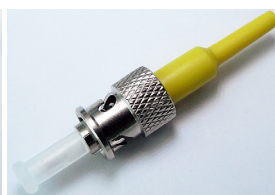

Type 3

Boots Colors



We can offer many colors boot

Ferrule for FC Connector

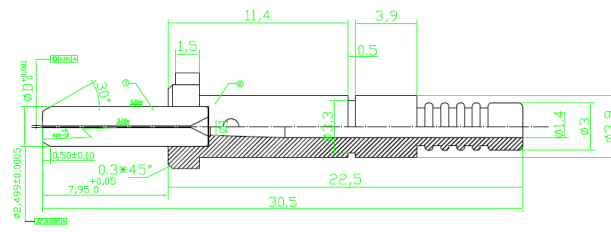

Concentricity $< 1.0 \mu\text{m}$ for standard quality demand
 Concentricity $< 0.3 \mu\text{m}$ for IEC grade B demand

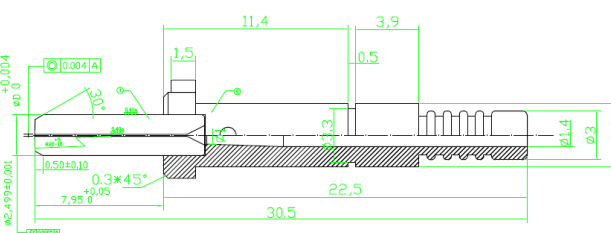

Concentricity $< 4.0 \mu\text{m}$ for standard quality demand
 Concentricity $< 1.4 \mu\text{m}$ for IEC grade B demand

ST 0.9mm Solid Boot Connector Drawing

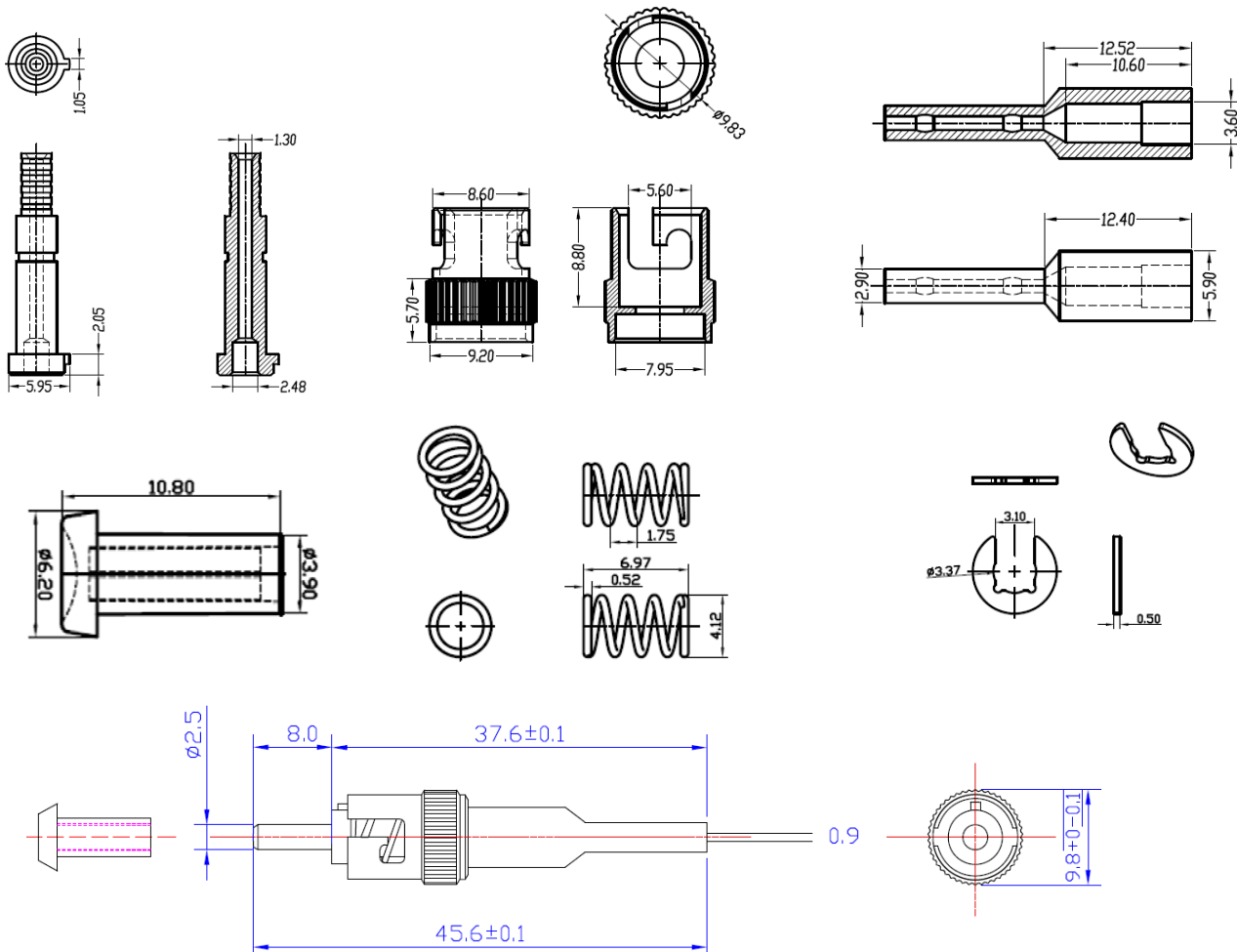
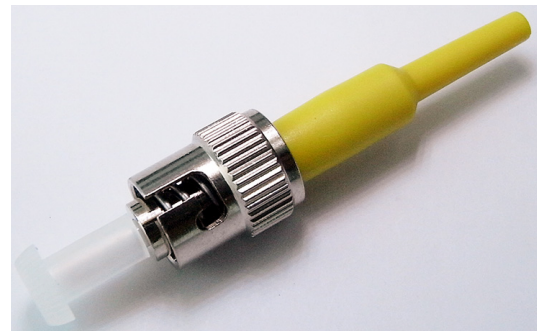

ST 2.0mm Boot Connector Drawing

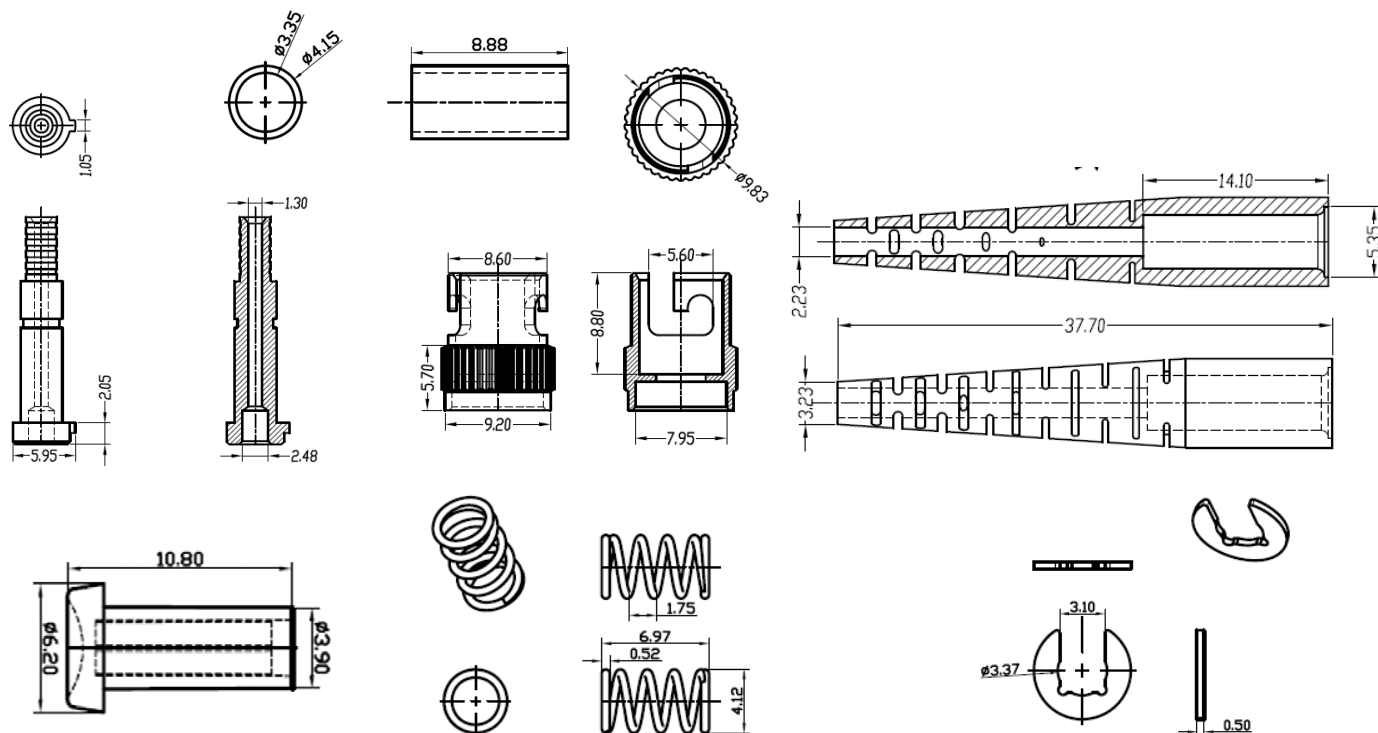

ST 3.0mm Boot Connector Drawing

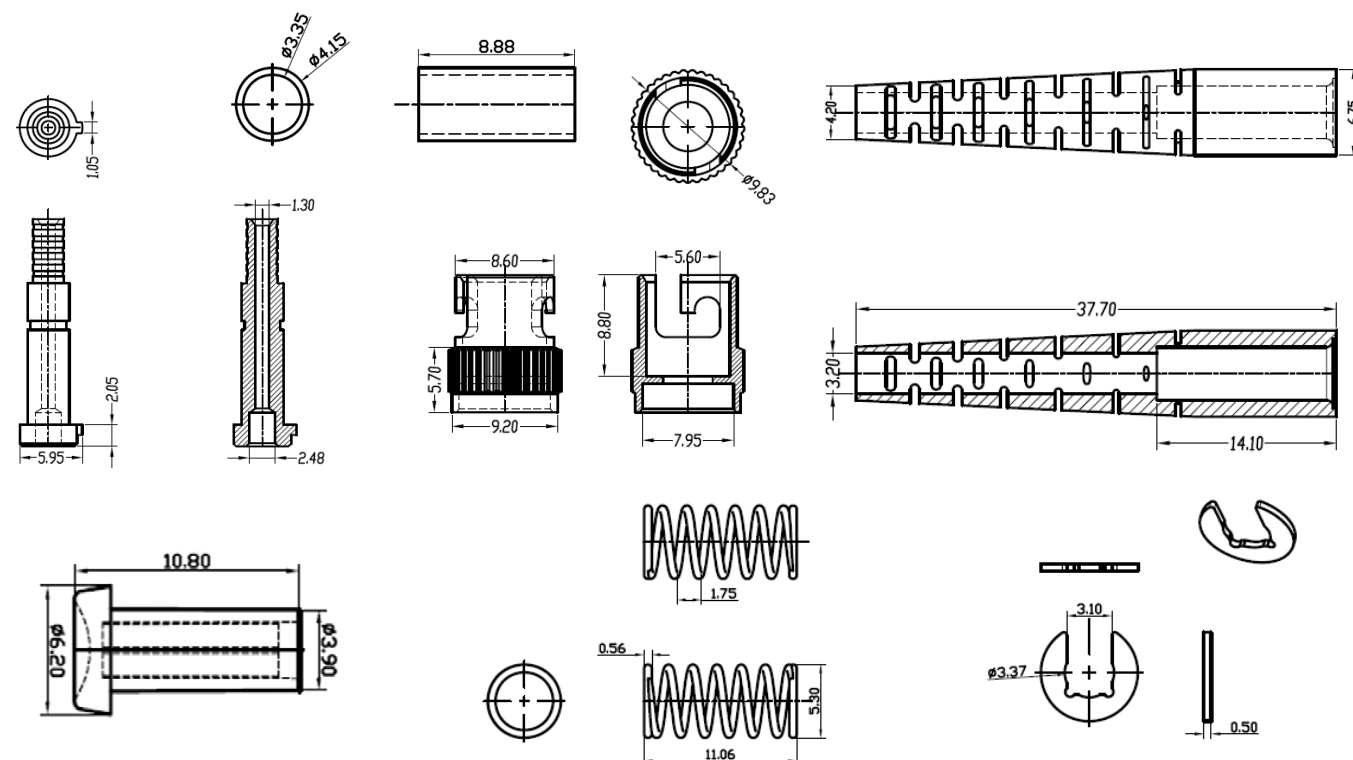

Order index

Products	-	Connector	-	Fiber Mode	-	Housing	-	Boot Size	-	Boot Color	-	Assembly
G- Fiber Connector		D-ST PC		1 - SM PC		1-Type 1		1- 0.9mm		A - Blue		0- not assembled
		H-ST APC		2- MM PC		2-Type 2		2- 2.0mm Hollow Boot		B- Orange		1-Assembled
				3- SM APC		3-Type 3		3 - 3.0mm Hollow Boot		C- Green		
										D- Brown		
										E- Grey		
										F-White		
										G-Red		
										H-Black		
										I-Yellow		
										J-Purple		
										K-Pink		
										L-Aqua		
										M-Magenta		