

DATASHEET

ST Fiber Adapter

Standard ST adapter-Simplex



SC Footprint ST Adapter-Simplex

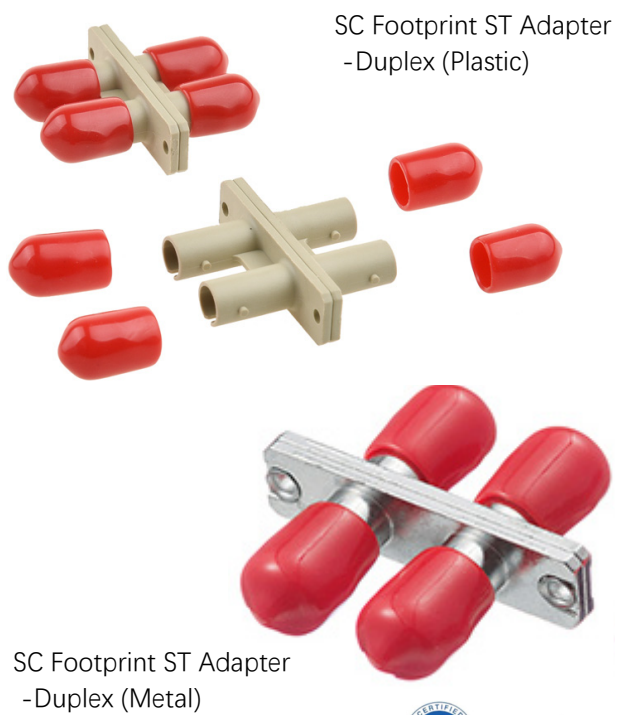

SC Footprint ST Adapter
-Duplex (Plastic)

SC Footprint ST Adapter
-Duplex (Metal)



OMC INDUSTRY CO.LIMITED

Description

ST fiber adapters are developed to couple and mate two ST connector plugs. The housing of the Adapters of the last generation has a reference key for the right position coupling and zirconia split sleeve for high alignment.

OMC Adapters design, material and manufacturing process assure long life and high repeatability of optical performances even for different brand connectors mating.

Products Materials

Parts name	Material	Color
Housing body	nickel-plated zinc	-
Sleeve	High precision Ceramic sleeve	-
Nut	Brass	-
Washer	Brass	-
Ring	Brass	-
Dust Cover	Rubber	Red/Black/Yellow

Optical Specifications

Test item	(SM-9/125) UPC	(SM-9/125) APC	MM PC
Insertion Loss	$\leq 0.2\text{dB}$	$\leq 0.2\text{dB}$	$\leq 0.2\text{dB}$
Return Loss	$\geq 50\text{ dB}$	$\geq 60\text{ dB}$	$\geq 35\text{ dB}$
Durability (500 Mating)	0.1dB Max.		
Withdrawal force (g/f)	2.0N ~ 5.9N (200gf ~ 600gf)		
Storage Temp (°C)	-40 ~ +85		

Available for Simplex of SM UPC, SM APC, MM OM1 62.5/125, MM OM2,OM3,OM4 50/125

Products Details



Standard ST adapter-Simplex

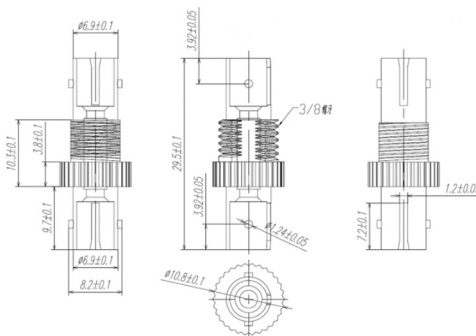

SC Footprint ST adapter-Simplex

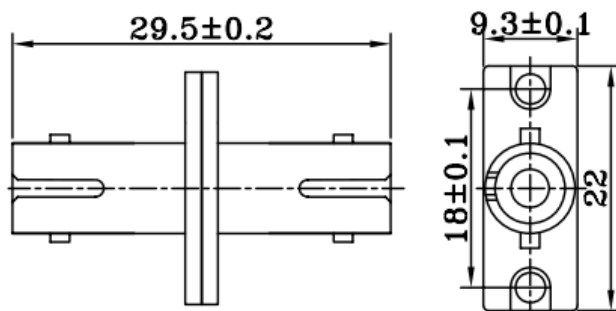

Products Details

*SC Footprint ST Adapter
-Duplex (Metal)*

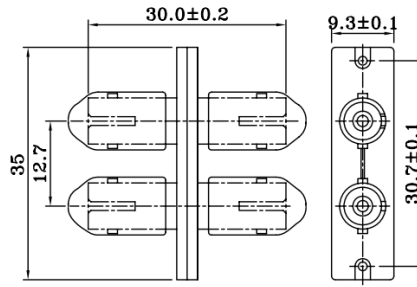

*SC Footprint ST Adapter
-Duplex (Plastic)*

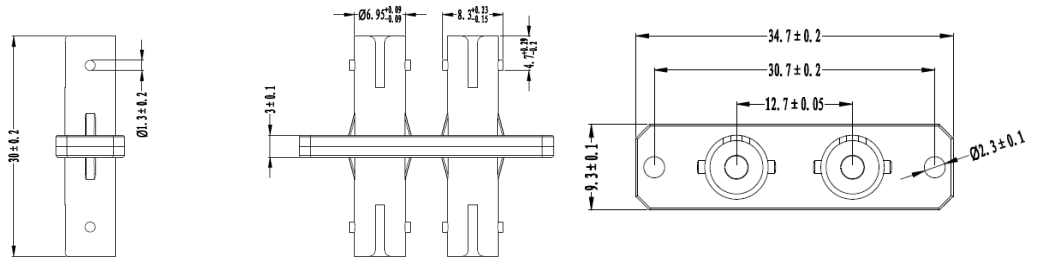
Features:

- Corrosion resistant housing
- Precision connection with sleeve
- SM and MM connector can be used interchangeably
- Low insertion loss, High Return loss
- Good interchangeability and reliability
- Meet IEC and ROHS standards
- High precision of mechanical dimensions Accuracy

Application:

- Patch panels, ODF and other optical connections.
- Optical networks demarcation and monitoring point

Order index

Products	Ports	Fiber Port	Structure	Cap Color
H6- Fiber adapter	1-Simplex	4 - ST	1- D Hole (Standard, Metal)	1 - Black
	2-Duplex		2- SC footprint (Metal)	2 - Red
			3 - SC footprint (Plastic)	3 - Yellow
			4 - D Hole (Standard, Plastic)	