

DATASHEET

MU Fiber Optic Connector



RoHS



OMC INDUSTRY CO.LIMITED

Description

The MU connector was developed by NTT. MU fiber connector is with square shape and push-pull mating mechanism. The MU Connector looks a miniature SC with a 1.25 mm ferrule. It has the same push/pull style, but can fit 2 channels in the same Footprint of a single SC. So MU is a small form factor SC. MU fiber connector represent the trend of the new generation fiber connectors to be smaller, thus they could fit for dense installations.

OMC manufactures many sorts of fiber connectors. Such as SC,LC,ST,FC,MU,MTRJ,E2000 ,MPO,MTP,SMA,DIN,D4 etc.

Industrial Standard:

MU: TIA/EIA-604-3A, GR-326.NTT-MU, JIS and IEC.

Products Details

Fiber Connector	MU	Ferrule Material	Zirconia Ceramic
Housing	SM: Brown APC: Green	Boot Size	0.9mm, 2.0mm, 3.0mm
Operating Temp Range	-40~80°C	Boot color	SM: Blue APC: Green
Suit Cable	0.6-2.0mm OD cable	Available for	Not assembled Multi-Piece Pre-assembled one piece

Optical Performance:

Meets Telcordia GR-326-Core issue

IL(Typical):SM<0.3dB; MM <0.3dB:

RL(Typical):SM >50dB; MM >35dB:

Environmental Performance:

Operating Environment: -40°C ~ + 80°C

Meets UL94-V0 Flammability Requirements

ROHS compliant

Mechanical Performance:

Connection Durability: 500 Matings cycles

Connector Repeatability: MM<0.2dB; SM <0.1dB

Applications

High-Density DWDM

Telecommunications

Test Instruments

Broadband Networks

Data Centers

Features

High-Density Package

High-Optical Performance

NTT Compatible

TIA-604 Compliant

Push-Pull Type Operation

Small Size and Lightweight

Telecordia GR-326 Qualified



0.9mm boot MU



2.0mm boot MU

Ferrule for MU Connector

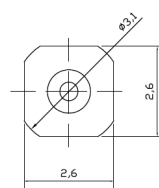
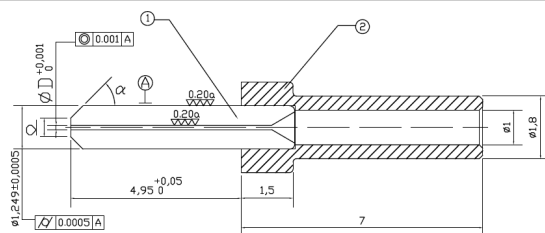
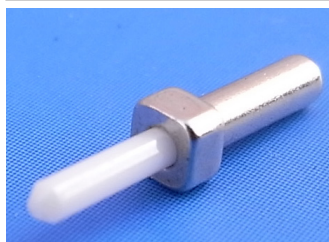

Concentricity<1.0um for standard quality demand

Concentricity<0.3um for IEC grade B demand

MU 0.9mm Solid Boot Connector Drawing

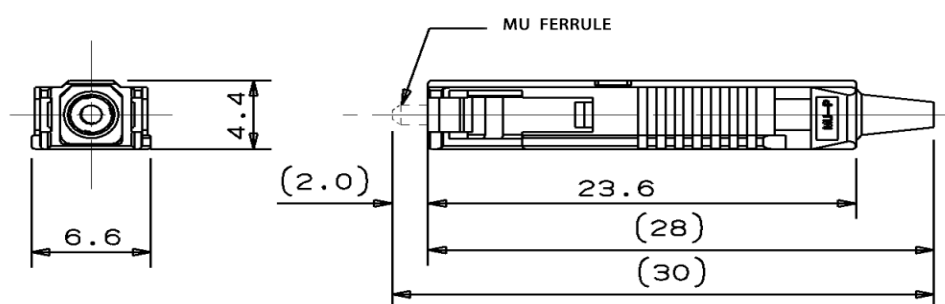

MU 2.0mm Hollow Boot Connector Drawing

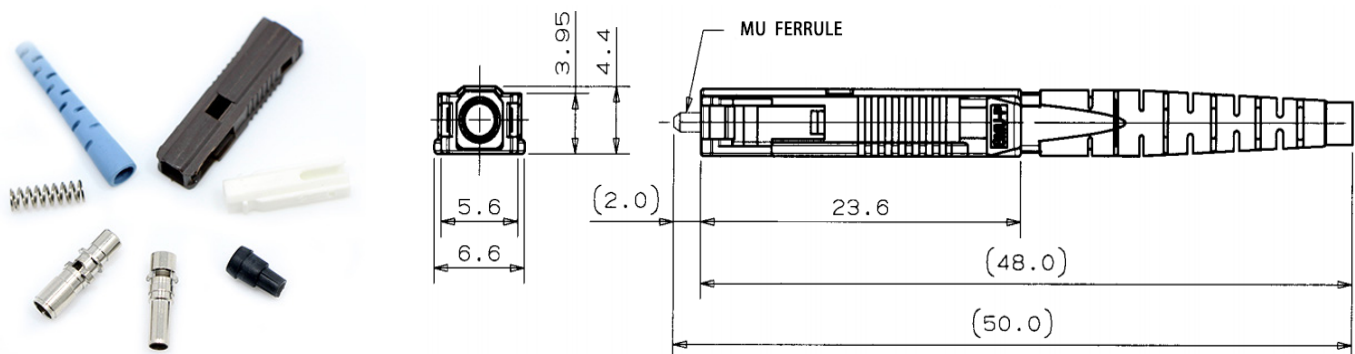

Order index

Products	Connector	Fiber Mode	Boot Size	Boot Color	Assembly
G- Fiber Connector	O-MU PC	1 -SM PC	1- 0.9mm Solid boot	A - Blue	0- not assembled
	P-MU APC	2- MM PC	2- 2.0mm Hollow Boot	B- Orange	1-Assembled
		3- SM APC		C- Green	
				D- Brown	
				E- Grey	
				F-White	
				G-Red	
				H-Black	
				I-Yellow	
				J-Purple	
				K-Pink	
				L-Aqua	
				M-Magenta	