

# DATASHEET

## LC Female to LC male Plug-in Fixed attenuator

---

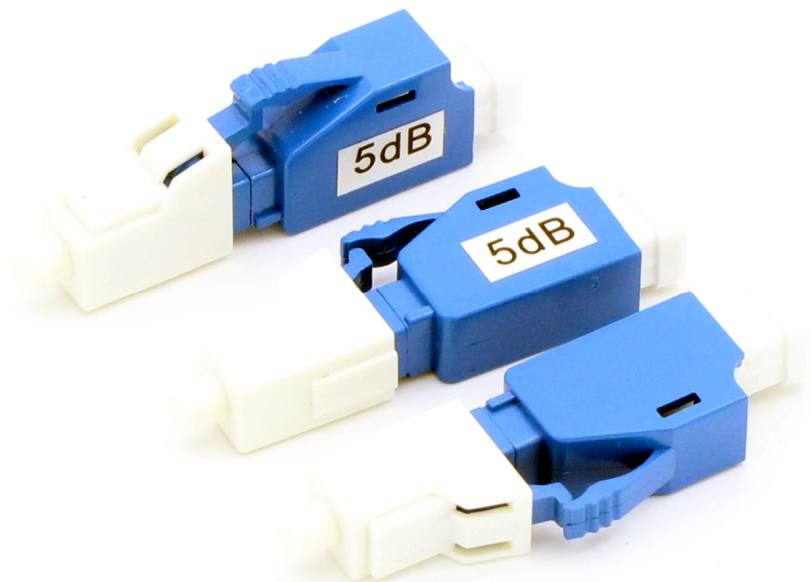

OMC INDUSTRY CO.LIMITED

2018|En version1.0



## LC Female to LC male Plug-in Fixed attenuator

### Description

Optical attenuator is a passive device used to reduce the power level of an optical signal. It is generally used in single-mode long-haul applications to prevent optical overload at the receiver. Optical attenuator is widely used in CWDM&DWDM, CATV systems, data center networks, test equipment and other high power applications. Though its applications range widely, fixed attenuators are most commonly used for test and measurement, optical sensors, and telecommunications applications.

Female to male Fixed attenuators from OMC offer defined control of optical signals in both integrated and add-on products. Depending on the project or need, fixed attenuators can limit (attenuate) the amount of light passing through to the exact levels your project or application requirement. These precise attenuation levels provide for highly accurate performance.

**OMC's LC Female to LC male Fixed attenuator are available for SM UPC (1-25dB) and SM APC (1-25dB).**

### Attenuator Specifications

Items	Parameters	
	SM	MM
Operating Bandwidth:	1310/1550nm (1200nm-1600nm)	850nm
Return Loss	UPC $\geq$ 50db, APC $\geq$ 60db	PC $\geq$ 35db
Attenuation Tolerance	1 ~ 5db $\pm$ 0.5db & 6 ~ 25db $\pm$ 10%	
Vibration	10 ~ 55hz(2hr)	
Max Optical Input Power	200mw	
Operating temp	- 40°C to +85°C	

### Features

- Precise Attenuation Values
- Low PDL&Insertion Loss
- Precise Reflection Polishing
- Fast Connection
- Stable attenuation, highly Reliable
- Complies with industry green initiative such as ROHS,
- GR910 Compliant

### Attenuator Application

Optical attenuator is a passive device used to reduce the power level of an optical signal. It is generally used in single-mode long-haul applications to prevent optical overload at the receiver. Optical attenuator is widely used in CWDM&DWDM, CATV systems, data center networks, test equipment and other high power applications.

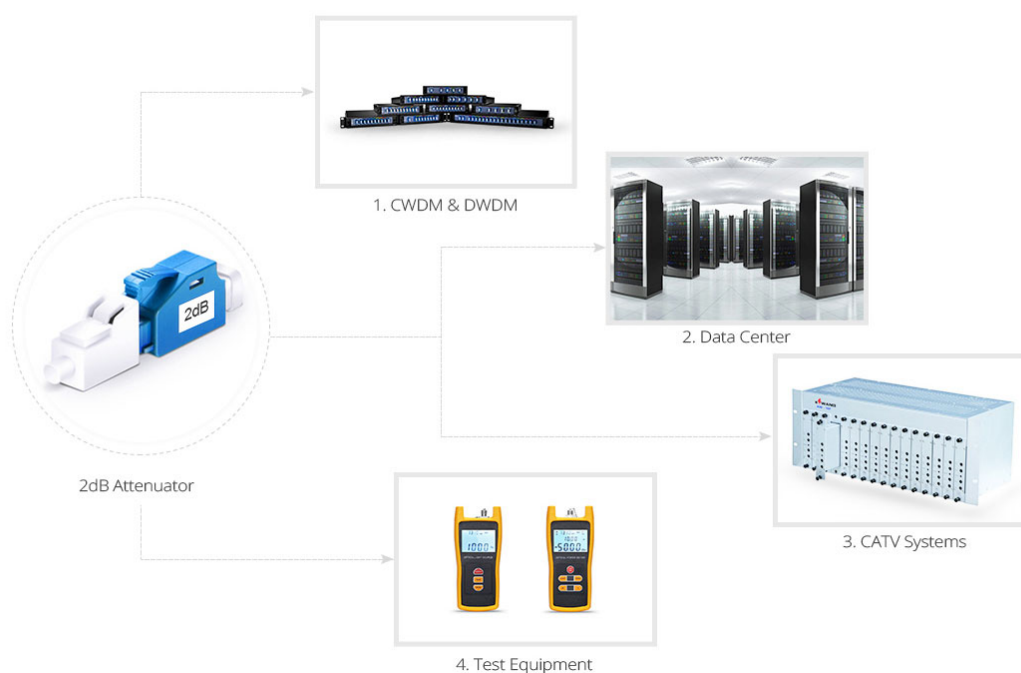



## LC Female to LC male Plug-in Fixed attenuator

### Products Materials

Parts name	Material
Connected body	PEI
Locking Body	PEI
Sleeve	High precision Ceramic sleeve
Sleeve Subassembly	Ceramic&SUS304
Inside hook	PBT/PEI
Spring	SUS304
Dust Cover	PVC

### Products Drawing

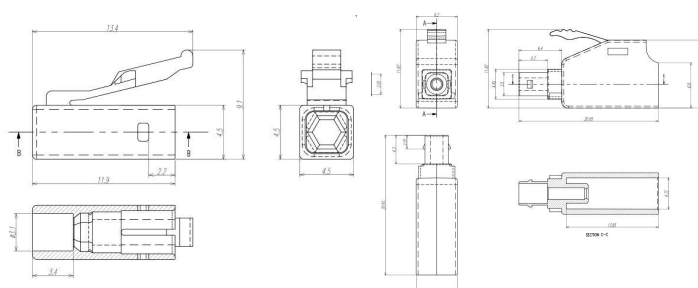

### Packaging

This easily taken and well-protected fiber optical cable package has been labelled and marked by OMC as default .Standard carton size : 34\*22\*15 cm; 44\*34\*24 cm ; 54\*39\*34 cm . Which carton to be used depends on goods Qty . Packing can be customized.



1, Single PE Bag



2, Paper Carton



3,fumig-free Pallet

### Order Index

Products	- Attenuation type	- Type	- Fiber Mode	- Female port	- Male connector	- attenuation
K - Attenuator	1- Fixed	1 - Female to male	0-SM	A-LC UPC	A-LC UPC	01- 1dB
			1-OM1	B—SC UPC	B—SC UPC	02- 2dB
			2-OM2	C-FC UPC	C-FC UPC	..
			3-OM3	D-ST UPC	D-ST UPC	...
			4-OM4	E- LC APC	E- LC APC	..
			5-OM5	F-SC APC	F-SC APC	...
				G-FC APC	G-FC APC	...
				H- MU UPC	H- MU UPC	
				I- MU APC	I- MU APC	
				J- E2000 UPC	J- E2000 UPC	
				K-E2000 APC	K-E2000 APC	
				1- MPO 12	1- MPO 12	
				2- MTP 12	2- MTP 12	
				3- MPO 24	3- MPO 24	
				4- MTP 24	4- MTP 24	